

Sensor averaging

Remove JP3 when using remote sensors

Sensor averaging ETC range of controls

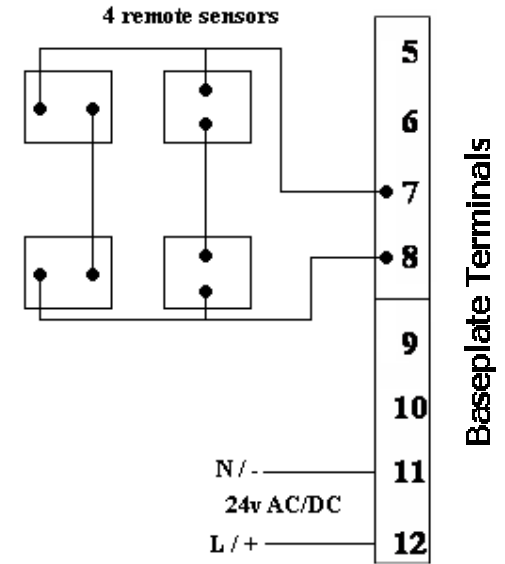
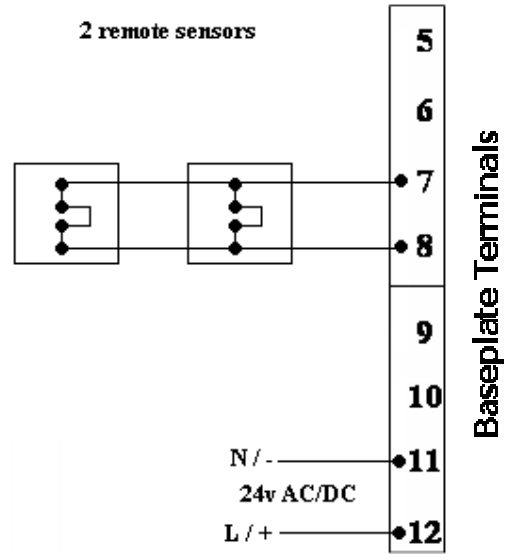
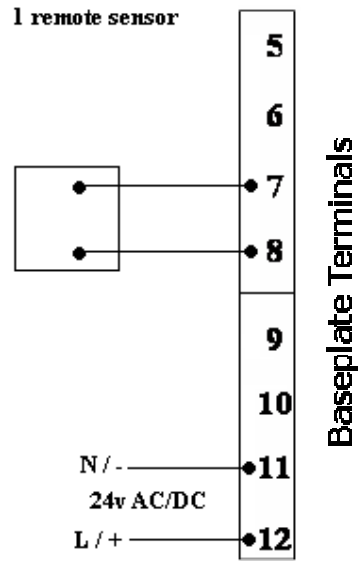

Set-up overview

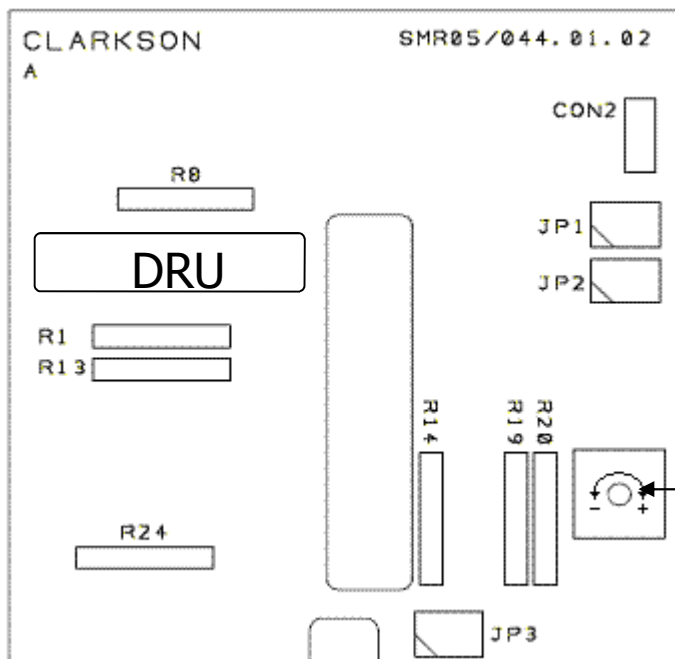

Override time period
30mins—3hrs

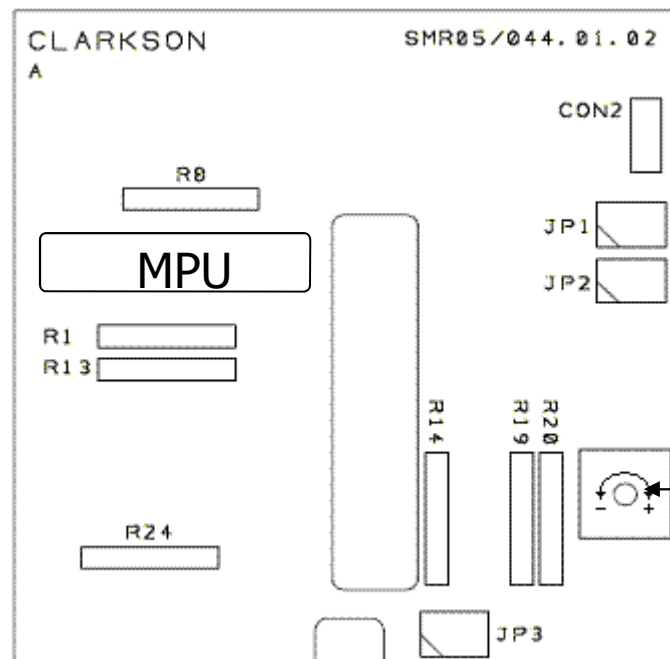

Opening period
30mins—3hrs
Link 5+6 for
permanent opening

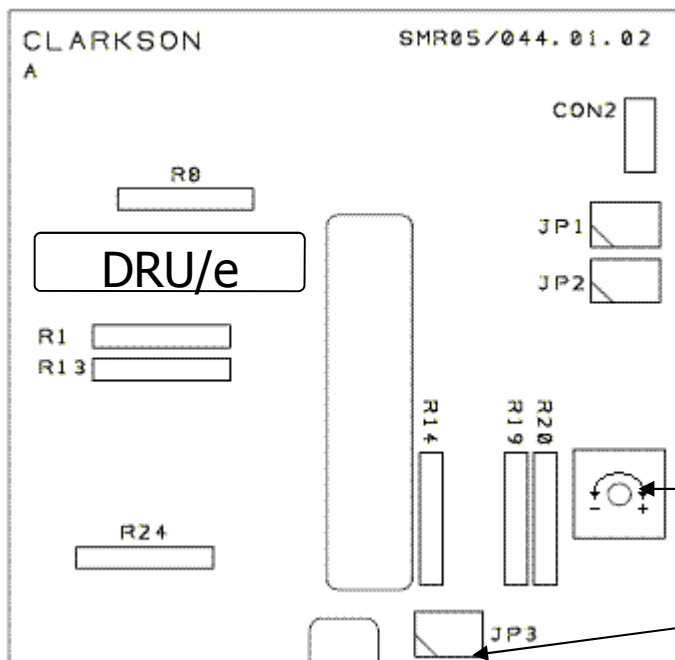

Override time period
30mins—3hrs

Remove JP3 when
Using remote sensors

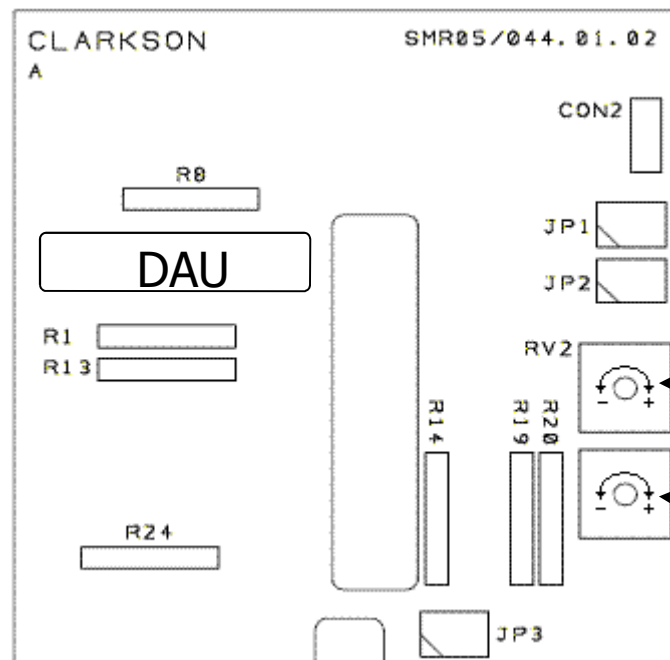

Alarm delay
5secs—5mins

Mute period
when in alarm
5secs—15mins

Dimensions (mm)

DRU 0/10 installation

Overall dimensions

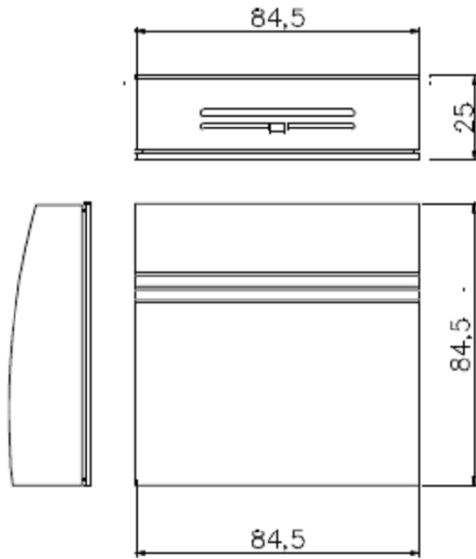

Baseplate

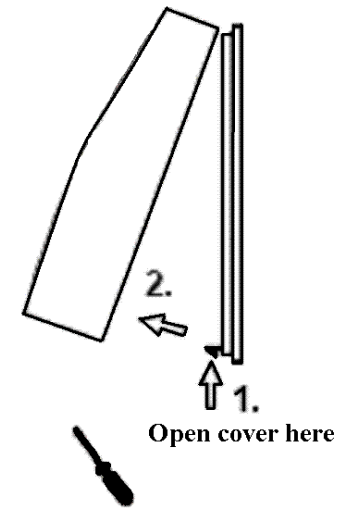
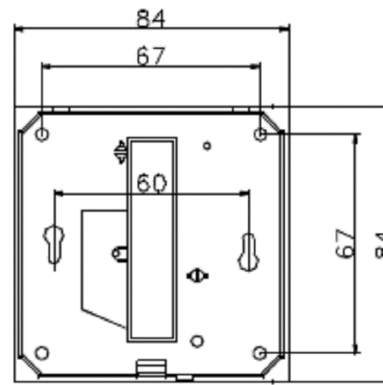

Connection diagram

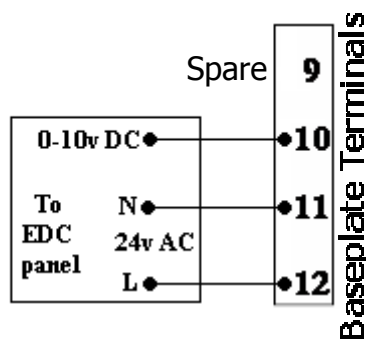

The unit contains a temperature sensor therefore due consideration should be given to location i.e. away from heat sources and direct sunlight .

Wiring should be undertaken using screened cable, with the screen earthed at one end only, provision is made at the temperature controller/panel for this purpose.

Mount and connect the base plate on to a smooth/flat surface. Fit in the correct orientation, at approx 1.5m high

Do not over tighten fixings as distorting the base plate will prevent correct alignment of the front plate. When using on dry lining / or conduit systems ensure no draughts are present by using filler/foam.

Connect unit up, as per diagrams and keep the front plate in a safe location until decoration is complete, fitting prior to commissioning.

Terminal connection plan

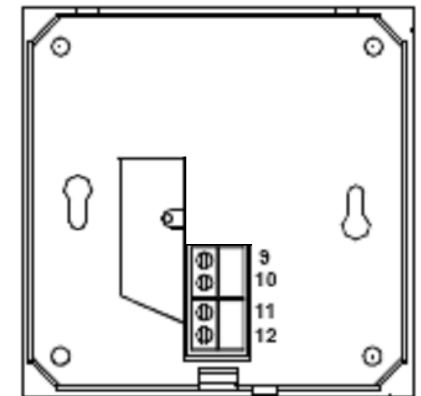

Dimensions (mm)

DRU/E installation

Overall dimensions

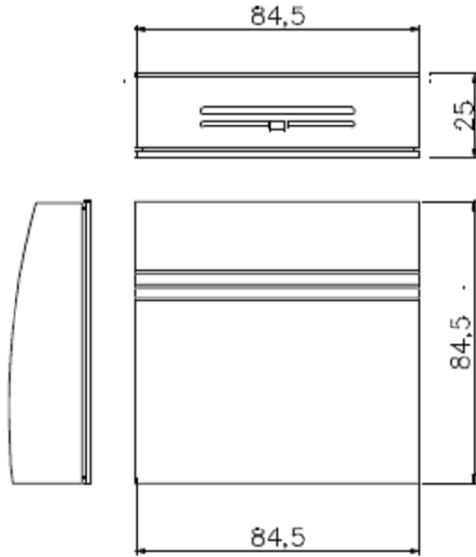

Baseplate

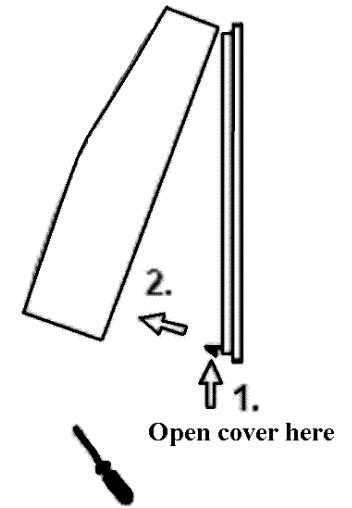
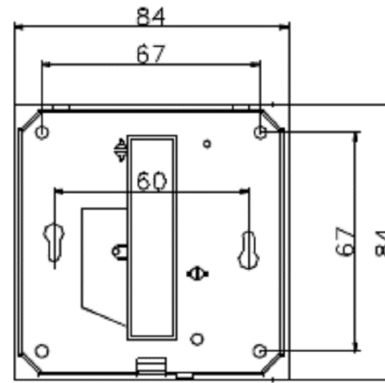

The unit contains a temperature sensor therefore due consideration should be given to location ie away from heat sources and direct sunlight .

Wiring should be undertaken using screened cable, with the screen earthed at one end only, provision is made at the temperature controller/panel for this purpose.

Mount and connect the base plate on to a smooth/flat surface. Fit in the correct orientation, at approx 1.5m high

Do not over tighten fixings as distorting the base plate will prevent correct alignment of the front plate. When using on dry lining / or conduit systems ensure no draughts are present by using filler/foam.

Connect unit up, as per diagrams and keep the front plate in a safe location until decoration is complete, fitting prior to commissioning.

Terminal connection plan

Connection diagram

